

PRODUCT OVERVIEW

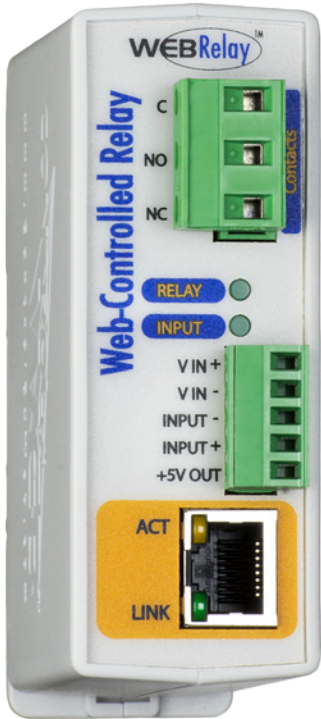

WebRelay™ provides reliable remote relay control and discrete signal monitoring over any IP network.

WebRelay can be used in countless applications, including pump and motor control, security lock systems, remote reboot, and lighting control.

WebRelay's powerful and flexible design make imagination its only limit.

In addition to its built-in relay, WebRelay has an optically-isolated input that can be used to monitor the state of devices, control the relay, or control a remote relay somewhere else on the network.

This feature is useful to extend the output of a PLC to another building, or to allow a switch or sensor to control a device at a distant location.

Features:

- No programming required.
- Full control using a standard web browser or text-based XML messages.
- Can operate as a Modbus TCP/IP slave.
- Password protected.
- 12-Amp relay contacts.
- On/Off and Pulse modes.
- Optically-isolated input can be used for:
 - Monitoring
 - Relay control
 - Remote relay control (Peer to Peer)
 - Automatic Reboot controller mode for remote reboot of computers and network devices.
- Selectable TCP ports.
- Two removable terminal connectors included.
- Rugged DIN-Rail/wall mountable enclosure.
- Two power supply options available:
 - 9-28 VDC
 - Power-Over-Ethernet (802.3af) or 5VDC



Setup

Network	Password	Relay/Input	Control Page Setup	Relay Control Page
Relay/Input:				
Relay Mode:	Standard <input checked="" type="radio"/> Automatic Reboot <input type="radio"/>			
Ping IP Address:	192 . 168 . 1 . 15			
Successful Ping Period:	60 secs			
Unsuccessful Ping Period:	10 secs			
Delay Before First Ping After Reboot:	120 secs			
Reboot Timer 1 (T1):	10 secs			
Reboot Timer 2 (T2):	5 secs			
Reboot Timer 3 (T3):	2 secs			
Reboot Options:	pulse off T1 secs			
Failed Pings Before Reboot:	5			
Max Reboot Attempts:	10			
Remote Relay Options:	no remote relay control			
Remote Relay IP Address:	192 . 168 . 1 . 3			
Remote TCP Port:	80			
Relay #:	0			
Password:	••••••••			
Keep Alive:	YES(No TX State)			
<input type="button" value="Submit"/> <input type="button" value="Reset"/>				

Automatic Reboot Options

Network	Password	Relay/Input	Control Page Setup	Relay Control Page
Relay/Input:				
Relay Mode:	Standard <input checked="" type="radio"/> Automatic Reboot <input type="radio"/>			
Pulse Duration:	1.5 secs			
Relay Options:	set relay equal input (init at powerup)			
Remote Relay Options:	no remote relay control			
Remote Relay IP Address:	192 . 168 . 1 . 3			
Remote TCP Port:	80			
Relay #:	0			
Password:	••••••••			
Keep Alive:	YES(No TX State)			
<input type="button" value="Submit"/> <input type="button" value="Reset"/>				

Relay Options

APPLICATIONS & SPECS

Shift Bell Controller



Computer

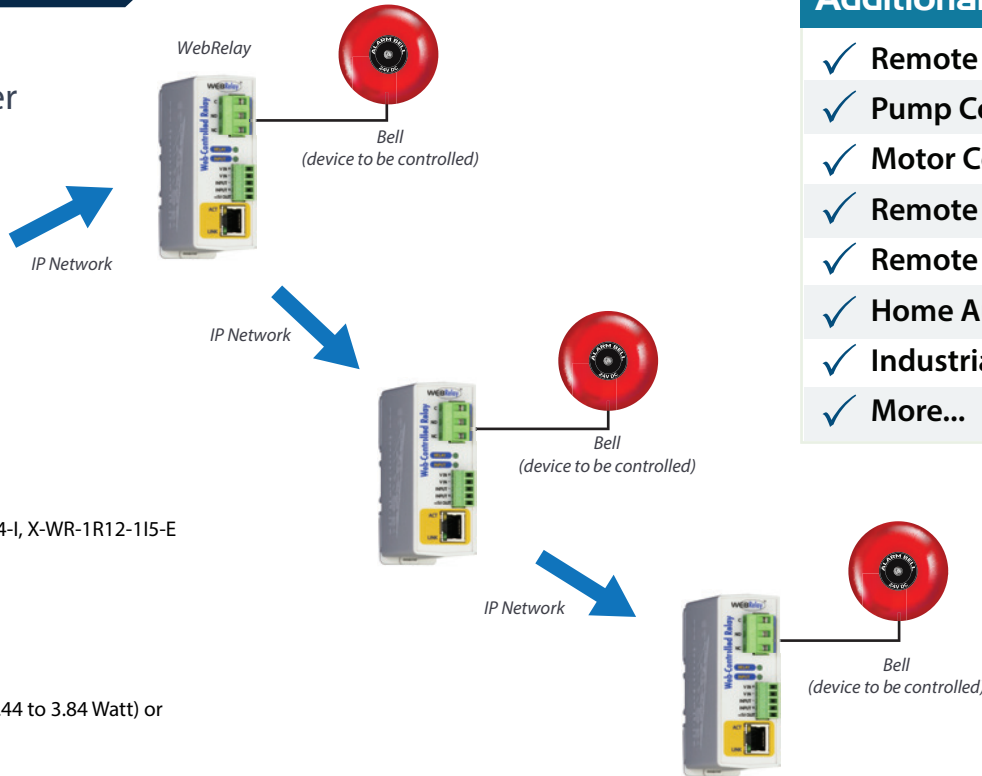

Additional Applications

- ✓ Remote Reboot
- ✓ Pump Control
- ✓ Motor Control
- ✓ Remote Relay
- ✓ Remote PLC Control
- ✓ Home Automation
- ✓ Industrial Automation
- ✓ More...

Models:

- X-WR-1R12-1I5-I, X-WR-1R12-1I24-I, X-WR-1R12-1I5-E

Power Requirements

- **Voltage:**
 - X-WR-1R12-1I5-I: 9-28VDC
 - X-WR-1R12-1I24-I: 9-28VDC
 - X-WR-1R12-1I5-E: POE Class 1 (0.44 to 3.84 Watt) or 5V±5%
- **Current:** 460mA Max

Relays

- **Number of Relays:** 1
- **Max Voltage:** 240VAC, 30VDC
- **Max Current:** 12A
- **Contact Type:** SPDT (Form 1C)
- **Load Type:** General Purpose
- **Contact Resistance:** < 30 milliohms initial
- **Contact Material:** AgSnO2
- **Electrical Life:** 100K cycles (Typical)
- **Mechanical Life:** 10M cycles (Typical)
- **Environmental Rating:** Over voltage Category II, Pollution Degree 2
- **Relay Modes:** ON/OFF or Pulsed
- **Pulse Timer Duration:** 0.1 to 86,400 Seconds (1-day)

Digital Inputs

- **Number of Inputs:** 1
- **Type:** Optically-Isolated
- **Voltage Range:**
 - X-WR-1R12-1I5-I: 4-12VDC
 - X-WR-1R12-1I24-I: 11-26VDC
 - X-WR-1R12-1I5-E: 4-12VDC
- **Current:**
 - X-WR-1R12-1I5-I: 4mA @ 4V, 16mA @ 12V
 - X-WR-1R12-1I24-I: 3.2mA @ 11V, 8.2mA @ 26V
 - X-WR-1R12-1I5-E: 4mA @ 4V, 16mA @ 12V
- **Minimum Hold Time:** 62.5mS
- **Input Isolation:** 1500V
- **Input Functions:** Monitor, Local Relay Control, Remote Relay Control

Network

- **Type:** 10/100 Base-T Ethernet Port
- **Setup:** Static IP address assignment. TCP port selectable

Connectors

- **Power/Input:** 5-Position Removable
- **Relays/Inputs:** 3-Position Removable
- **Network:** 8-pin RJ-45

LED Indicators

- **Number of LEDs:** 4
 - Digital input voltage applied
 - Relay coil energized
 - Network linked
 - Network activity

Physical

- **Operating Temperature:** -40°F to 150°F (-40°C to 65.5°C)
- **Size:**
 - 1.41in (35.7mm) wide
 - 3.88in (98.5mm) tall
 - 3.1in (78mm) deep (not including connector)
- **Weight:** 5 oz (142 grams)
- **Enclosure Material:** Lexan 940 Polycarbonate Plastic
- **Enclosure Flame Rating:** UL94 V0

Protocols

- HTTP, XML, Modbus TCP/IP

Logging

- **Log File Size:** 512K (max 28,829 logs)
- **Storage:** Nonvolatile Flash
- **Buffer Architecture:** Circular Buffer
- Log data can be periodically read and stored on a computer

Advanced Features

- BASIC interpreter
- Remote services - Avoid most firewall issues with outbound connection to Web Services

Password Settings

- **Password protection on setup page:** Yes
- **Password protection on control page:** Optional
- **Password Encoding:** Base 64
- **Max Password Length:** 10 Characters